

# Handheld Remote Operation Manual

## Model No's: JSJS LW100

It is important to install this product in accordance with the fitting instructions below. Failure to do so may render your guarantee void.

**IMPORTANT: PLEASE RETAIN THESE INSTRUCTIONS FOR FUTURE REFERENCE AND FOR GUIDANCE ON THE ASSOCIATION OF REMOTE HANDSETS. FOR HELP AND SETUP GUIDANCE PLEASE VISIT [www.lightwaverf.com](http://www.lightwaverf.com)**

### OVERVIEW:

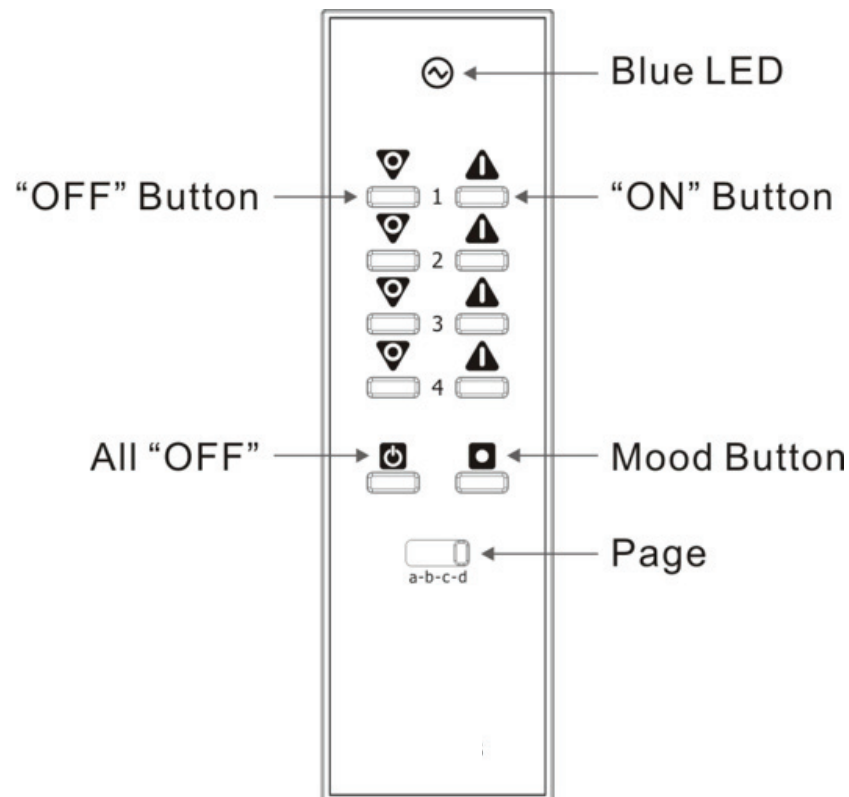

## SETUP:

The functions illustrated here relate to the operation of ON/OFF receivers such as Single and Double Sockets and the Plug-in Adapter Sockets, and to dimmable receivers; for information regarding how to pair the handset to the relevant receiver(s), please refer to the setup instructions for that individual device.

Before operation, ensure that the plastic film isolating the battery is removed (see later battery replacement diagram for guidance on how to access battery).

**NOTE:** If the RF range between the transmitter and receiver is too great to achieve reliable operation, the LightwaveRF Connect SIGNAL BOOSTER may be used in conjunction with this product to increase the signal strength over greater distances.

### Setting a Mood

To set up a mood:

1. Make sure all of the devices that are to be incorporated into the mood are paired with the mood remote (see relevant receiver device instructions for details of how to do this).
2. Set the desired output status (i.e. ON or OFF) or dim level of all of the receivers to be incorporated into the mood – this is how they will appear when the mood is activated.
3. Hold down the 'Mood' button for 5 seconds.

4. The handset LED will flash for 3 seconds.

5. The Handset will then send a 'store mood' code to all paired receivers, which will flash to show confirmation.

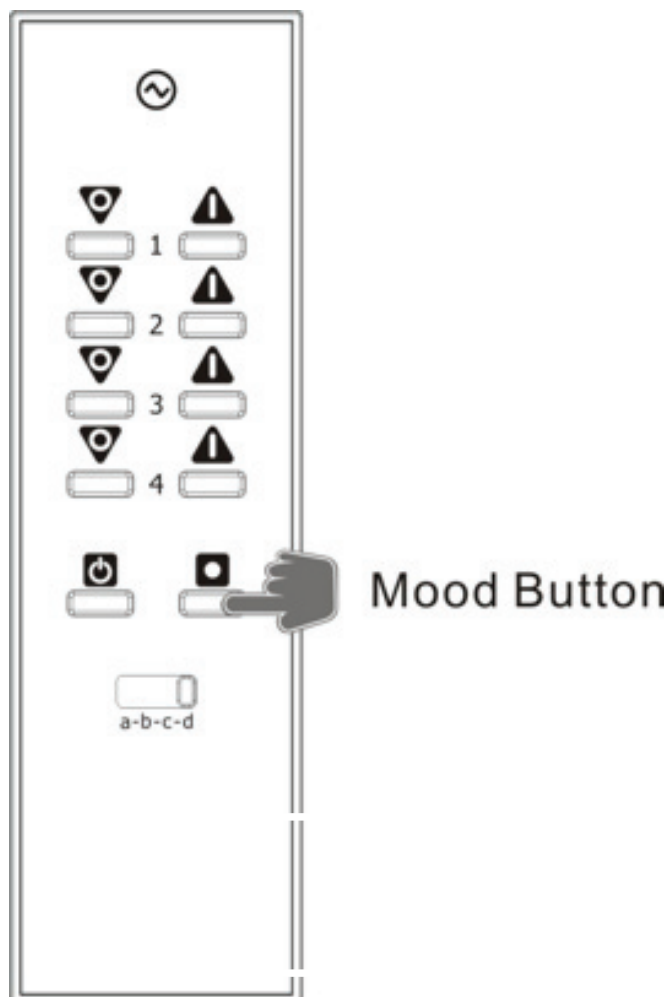

## OPERATION :

### **1) Linked to an 'ON/OFF' receiver (eg Room Control single, double or plug-in sockets):**

**'ON'** Button - Press once to switch 'ON'.

**'OFF'** Button - Press once to switch 'OFF'.

**'ALL OFF'** Button - Press once to switch off all paired receivers at the same time.

## 2) Linked to a 'Dimmer' receiver (e.g. Room Control Single Dimmer or dimmable CFR):

### Lowering Dim Level

1. Make sure the light is switched on.
2. Hold down the 'OFF' button.

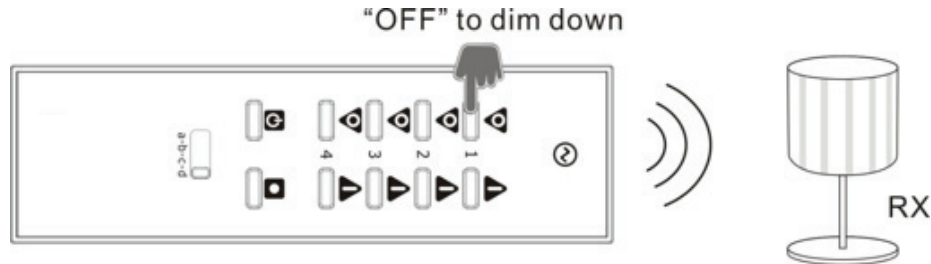

3. After 1 second the light will start to dim.
4. At the desired brightness level release the 'OFF' button.

**NOTE:** If the 'OFF' button is not released, the light will continue to dim until it reaches its lowest possible level (without being turned off) and stop.

### Raising Dim Level

1. Make sure the light is switched on.
2. Hold down the 'ON' button.

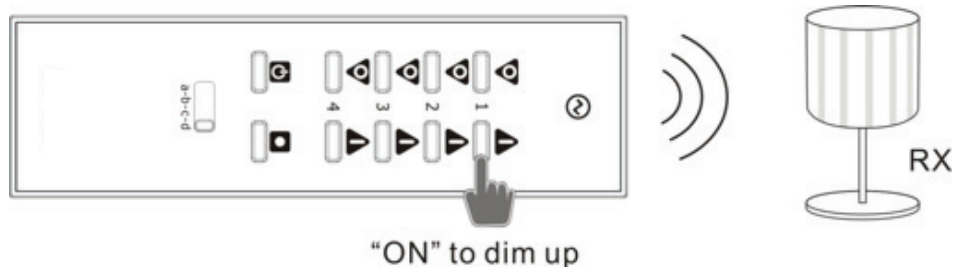

3. After 1 second the light will start to become brighter.

4. At the desired brightness release the 'ON' button.

**NOTE:** If the 'ON' button is not released, the light level will increase until it stops at the maximum possible level of brightness.

After setting a dim level using the handset the light is then switched off. The next time the light is switched back on again the dim level will automatically return to the previously stipulated setting.

### **BATTERY REPLACEMENT:**

3V CR2032 lithium battery is included.

When battery voltage is low, transmission is low.

Slide down the battery cover and replace with a fresh new battery.

### **NOTE:**

- Connect correctly and securely
- Do not recharge
- Keep away from children
- Do not swallow (If swallowed, seek medical advice immediately)
- Please dispose of used batteries responsibly

## **SPECIFICATION:**

RF frequency: 433.92 MHz

Battery: 3V CR2032 lithium cell battery operated  
(included)

Blue LED indicator



Birmingham Science Park Aston  
Faraday Wharf  
Holt Street  
Birmingham  
B7 4BB

Tel: 01902 500 562  
Email: [support@jsjsdesigns.com](mailto:support@jsjsdesigns.com)